

TRANSMISSION BELT:

1. Remove the transmission cover and inspect the belt for wear, damage, or breaks.
2. Fraying on sides of belt is considered normal.
3. To replace the belt, remove the clutches and remove the old belt. Install new belt onto clutches and simultaneously install the clutches. Refer to "Clutches" for more detailed information.

CLUTCHES:

Tools Needed for Service:

- 6mm Allen Wrench
- 1-1/8" Socket Wrench
- Torque Wrench
- Chisel
- 5/16 Allen Wrench
- Hammer

Transmission Removal

- A1.) Remove the bolts holding on the transmission cover with a 6mm Allen Wrench and remove the cover away from the motorcycle. Refer to bolt #11 in Figure 3.

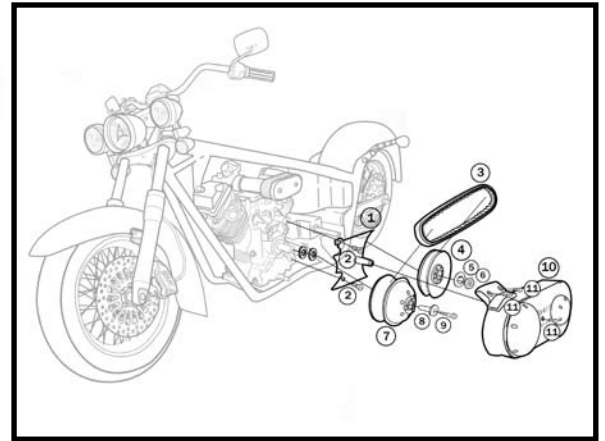

Figure 3

CLUTCHES (continued):

A2.) Bend the tab on the driven washer with a chisel. Remove both the bolt and nut holding the clutches onto the transmission as well as the washers. Refer to numbers 5,6,8 and 9 in Figure 3. Number 9 is for the drive and number 6 is for the driven. Use a 5/16 Allen for the bolt and a 1-1/8 socket wrench for the nut.

A3.) Remove the drive and driven at the same time. Remove the belt from the clutches. Refer to number 3 in Figure 3.

Drive Clutch Service

B1.) Remove the clutch cover by bending down the tabs and removing the bolts. Refer to Figure 4.

B2.) Remove the snap ring using a pair of snap-ring pliers. See Figure 5.

*NOTE:

Make sure to use caution when removing the snap ring. The snap ring can "spring" off during removal and can cause damage to the eyes if not careful.



Figure 4



Figure 5

CLUTCHES (continued):

B3.) Remove the “bell” cover.

B4.) Using Comet GP-730 A Lubricant, lube each roller by spraying the lube into one side of the roller enough that the lubricant comes out the other side of the roller. Make sure you lube all three rollers. Refer to Figure 6 and 7.

B5.) Lube the springs by spraying on the Comet Lubricant. Make sure all 6 springs are lubed adequately.

B6.) Open up the clutch by pressing down on the sleeve that is most upwards until it “pops” into place.

B7.) Using the lubricant spray onto each shaft. Lube all three outer shafts and the larger inner shaft. Also see Figure 7.

B8.) Make sure all moving parts have been lubricated and allow the lubricant to dry.

B9.) Once the lubricant has been given time to dry place the “bell” cover back onto the clutch.

B10.) Re-install snap ring back onto the clutch using snap ring pliers.



Figure 6

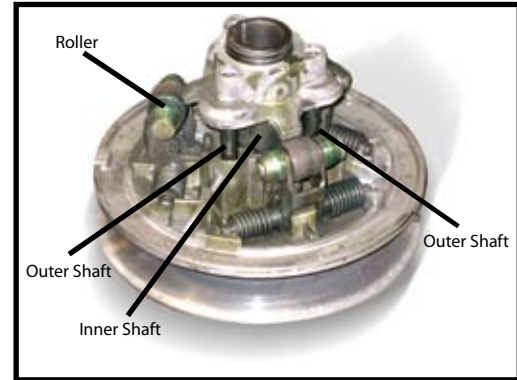

Figure 7

CLUTCHES (continued):

B11.) Place washers on and bolt the cover on hand-tight using the original hardware. Tighten bolts with wrench after bolting the cover on to secure into place.

B12.) Pop the clutch back up and tap the tabs with a hammer to secure into place.

Driven Clutch Service

C1.) Make sure all of the cam buttons are still on the clutch and intact. See Figure 8. If not intact contact Ridley.

C2.) Check bolts on back part of clutch and make sure all the bolts are tight and in place.

C3.) Using Comet GP-730 A Lubricant lubricate the cam buttons. See Figure 9.

C4.) Lubricate the shaft and spring inside the clutch.

*NOTE:

Make sure to NEVER lubricate the sheaves on the clutches or the belt. Lubricating the sheaves or belt may cause "slippage" of the transmission.



Close up of cam buttons.

Figure 8

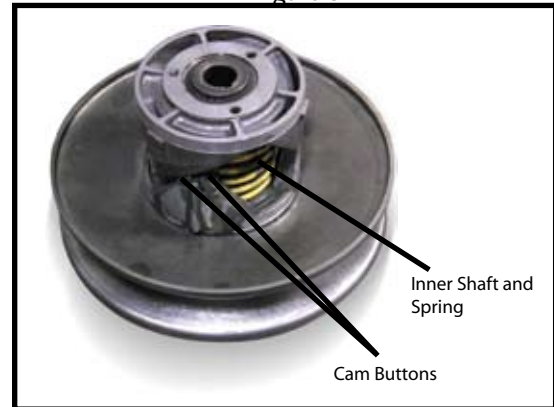

Figure 9

CLUTCHES (continued):

C5.) Lubricant requires time to dry before placing the driven clutch back onto the jackshaft.

Installation

D1.) Place the transmission belt on the two clutches.

D2.) Simultaneously install the drive and driven onto the correct keyed shafts. (Drive-Engine/Driven-Jackshaft.) Refer to Figure 10.

D3.) Place the washer on the drive, then bolt into place with the original hardware at a recommended 30 ft./lbs. of torque.

D4.) Place on the washer and torque the nut onto the driven at a recommended 50 ft./lbs. of torque.

D5.) Bend the tab on the washer that was just installed on the driven by tapping it with a hammer. See Figure 11.

D6.) Reinstall transmission cover and tighten the bolts to a recommended 156 in./lbs. of torque. Use a 6mm Allen wrench.



Figure 10



Figure 11